

Type	
Project	
Catalog No.	

Model # IG-TR14-22W



SPECIFICATIONS

- Input Voltage: 120V AC
- Power: 22W
- Frame Color: White, Black
- Dimming: Triac (Leading & Trailing)
- Optional Beam Angle: 15°, 24°, 38°, 60°
- IC Rating: Dry Locations
- Power Factor: >0.9
- Base: 3 wire 1 circuit
- Certification: ETL
- Life-span: 50000 hours
- 5 Years Warranty

ADAPTORS FOR CHOICE



H-Type Adaptor

J-Type Adaptor

L-Type Adaptor

DESCRIPTION

Precise and variable accent lighting in the shop and retail sector. The water-drop design inspired by Action Movie Star Bruce Lee's "BE LIKE WATER". The water-drop design is unique and patented, which is beautiful and self-cleaning. Nearly 50% energy saving compare to ceramic metal halide thanks to the high efficacy over 90lm per watt. CRI82 and CRI95 options and within 4-step MacAdam ellipses offer high quality lights for high end application. ETL, DLC and RoHS compliant.

FEATURES

- Interchangeable Beam: 15°, 24°, 38°, 60°
- CAMETA anti-glare design and with shield angle to reduce wide beam angle glare lights
- High efficacy: 90lm/w
- Dimmable: compatible with most of the dimmers in the market
- Integral driver, isolated circuit
- Passive cooling achieved by innovative thermal design
- 350° horizontal rotation, 90° vertical adjustability
- Self-cleaning thanks to the water drop shape

SPECIFICATION

Model	Wattage	Color Temp	Lumen @ CRI 82 / 95*	Voltage	Beam Angle	Working Temp	Halogen Equivalent	Color
IG-TR14	22W	2700K*	2100 Lumen	120V AC	*15°	-20°C- +40°C	65W	White
		3000K	2200 Lumen		*24°			
		4100K*	2250 Lumen		38°			Black
		5000k	2350 Lumen		*60°			

*Custom Make

Ordering Information:

Example: IG-TR014-22W-27K-82-15°-WH

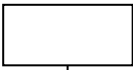

Model

IG-TR14

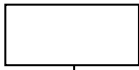

Wattage

22W = 22 Watts

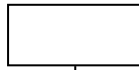

Color Temp

27K = 2700K*
30K = 3000K
41K = 4100K*
50K = 5000K

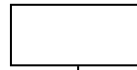

CRI

82
95*

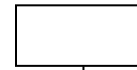

Beam Angle

***15°**
***24°**
38°
***60°**

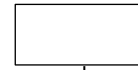

Finish

WH = White
BK = Black

Beam Angle 15°

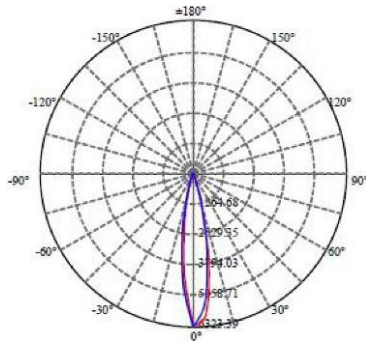

Lux distance Curve

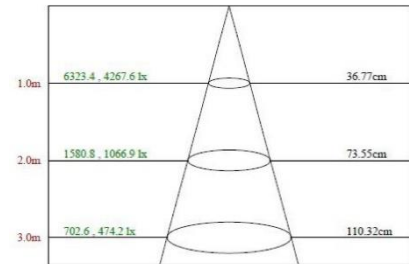

Max . Ave Beam angle of C270 plane 20.83

Beam Angle 24°

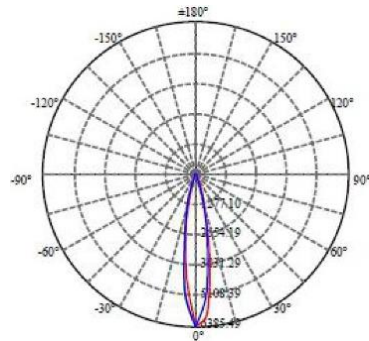

Lux distance Curve

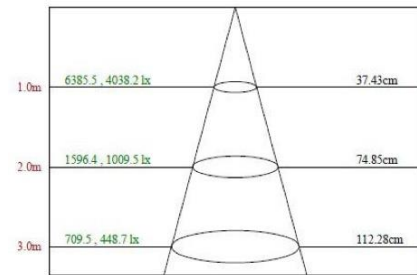

Max . Ave Beam angle of C270 plane 21.20

Beam Angle 38°

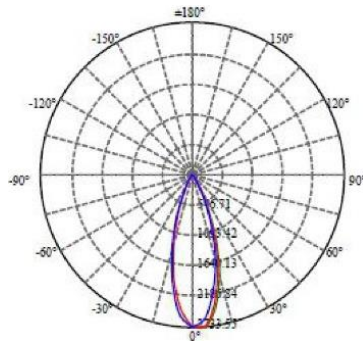

Lux distance Curve

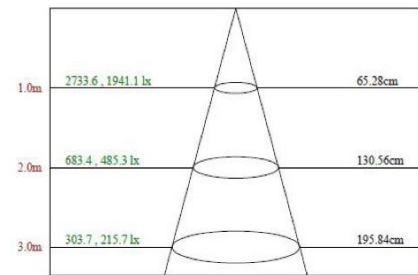

Max . Ave Beam angle of C45 plane 36.06

Beam Angle 60°

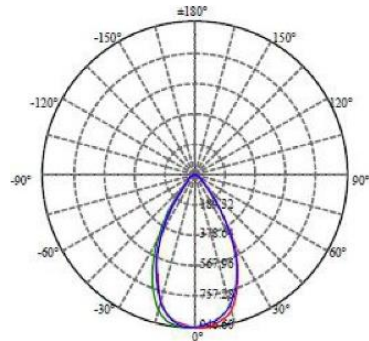

Lux distance Curve

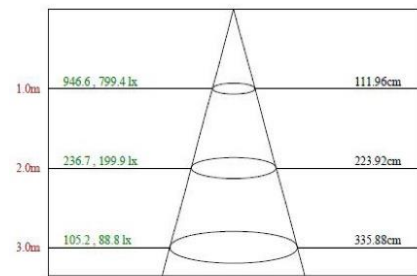

Max . Ave Beam angle of C315 plane 58.47

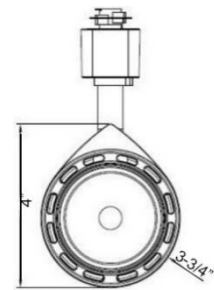
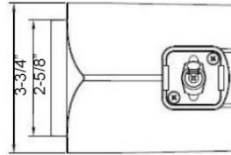
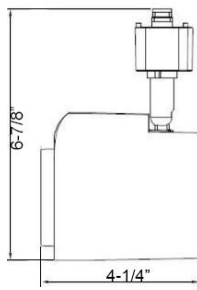

ACCESSORIES



Barn door



1. To power off, remove the original lamp.

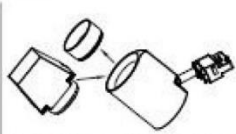

2. Place the lens face up, rotate the original lamp cover and take it, change into the barn door component and fix it.

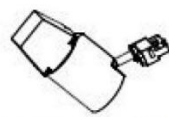

3. Ensure that installation is firm and reliable.

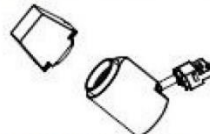

4. If need to rotate the angle of barn door, the barn door can be rotated right-hand alone, or pull out the oval snoot and adjust the angle, then to button up.

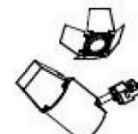

5. Ensure that installation is firm and reliable, adjust suitable angle, then electricity to lighten.



Honeycomb



1. To power off, remove the original lamp.

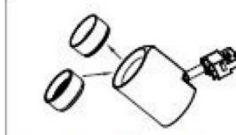

2. Place the lens face up, rotate the original lamp cover and take it, change into the honeycomb component and fix it.



3. Ensure that installation is firm and reliable, then electricity to lighten.



Oval snoot



1. To power off, remove the original lamp.

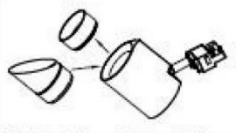

2. Place the lens face up, rotate the original lamp cover and take it, change into the oval snoot component and fix it.

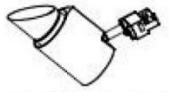

3. Ensure that installation is firm and reliable.

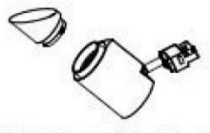

4. If need to rotate the angle of oval snoot, the oval snoot can be rotated right-hand alone, or pull out the oval snoot and adjust the angle, then to button up.



5. Ensure that installation is firm and reliable, then electricity to lighten.



Snoot

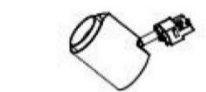

1. To power off, remove the original lamp.

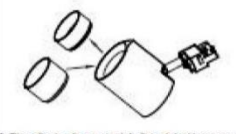

2. Place the lens face up, rotate the original lamp cover and take it, change into the snoot component and fix it.



3. Ensure that installation is firm and reliable, adjust the suitable angle, then electricity to lighten.